

### SMALL SOLENOID VALVES FOR WATER / Type HEV



Type HEV-G

#### FEATURES

- It can also be installed on vertical piping.
- Bronze valve body
- Normally Closed

#### APPLICATIONS

- Water boilers
- Water heaters
- Electric water heaters, etc.

#### COMMON SPECIFICATIONS

- Fluid Temperature : 0 ~ 95°C
- Ambient temperature : -10 ~ 50°C
- Normally Closed

#### DESCRIPTION OF CATALOG NO.

HEX - 10 04 G K W \* A 4 R  
 I II III IV V VI VII VIII IX

I	Type
II	Port Size
III	Connection tube O.D.
IV	Connection type
V	Pressure class
VI	Fluid
VII	Coil power supply
VIII	Coil voltage
IX	Coil Style

#### TYPE NUMBER SELECTION

Catalog No.				Port Size (mm)	Cv Value	Connection		O.P.D. (MPa)		Max. working pressure (MPa)	Operation	* Wt. (kg)
Type	Model	Power supply / Voltage	Coil Style			Style	Connection size	Min.	Max.			
HEV	604GKW	* A1 (100V.AC) * A2 (200V.AC) * A4 (220V.AC)	R (Lead Wire) type	6	0.94	Rc	1/2"	0	0.10	0.10	Direct operated	0.27
	1004GKW	* A7 (24V.AC)		10				0.29	0.29			

\* Valve only (without coil)

#### SPECIFICATIONS OF COILS

Rated Voltage	Frequency (Hz)	Tolerance (%)	Voltampere (VA)		Power consumption (W)	Insulation Class	Coil Style (Lead Wire type)	Coil Wt. (kg)
			Running	Inrush				
24V.AC	50/60	± 10	12/9	30/23	5/4	Class B Molded	R (Lead Wire type)	0.13
100V.AC								
200V.AC								
220V.AC								

- Current (A) = Voltampere / Rated Voltage
- IP Lead Wire type : IP67

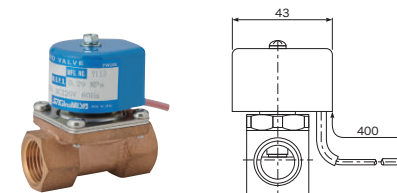

Lead Wire type (IP67) Unit : mm

#### DIMENSIONS

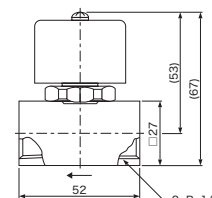

Type HEV-604GKW

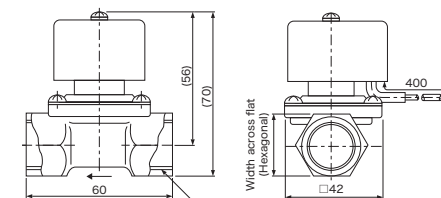

Type HEV-1004GKW

Unit : mm

#### FLOW CHARACTERISTICS

