

# CHECK VALVES

Type ACV & BCV

SAGInoMIYA

## GENERAL DESCRIPTION

- Install in the liquid line of heat pump air conditioner to prevent the counter flow at change over of cycles from heating to cooling and vice versa.
- Also for prevention of reverse flow of high pressure gas when compressor stops.
- For use with Fluorinated Refrigerants, and Inert Gas.
- Can be mounted in horizontal or vertical line.
- Valve material : Fluorocarbon resin



Type ACV-B



Type BCV

## TYPE NUMBER SELECTION (SPECIFICATIONS)

### Type ACV

Catalog No.	Fluid	Port Size (mm)	Cv Value	Connection		Max. Working Pressure (MPa) {kgf/cm <sup>2</sup> }	Allowable Liquid Temp. (°C)	Wt. (kg)	
				Copper Tube (O.D.)	Style			B	D
ACV-2B (D)	Fluorinated Refrigerants	4.8	0.55	1/4"	B: Flare D: Solder	3 {30.6}	-40 to 125	0.1	0.05
ACV-3B (D)		7.5	1	3/8"				0.2	0.1
ACV-4B (D)	Air	10	2.4	1/2"				0.4	0.2
ACV-5B (D)		12.5	4.2	5/8"				0.5	0.3
ACV-6B (D)	Inert Gas	16	6	3/4"				0.7	0.5

### Type BCV

Catalog No.	Fluid	Port Size (mm)	Cv Value	Connection		Max. Working Pressure (MPa) {kgf/cm <sup>2</sup> }	Allowable Liquid Temp. (°C)	Wt. (kg)
				Copper Tube (I.D.)	Style			
BCV-302DY	Fluorinated Refrigerants	3	0.33	1/4"	Solder	4.15 {42.3}	-30 to 120	0.02
BCV-603DY		5.5	0.97	3/8"				0.04
BCV-804DY		8	2	1/2"				0.07
BCV-1005DY		10	3.5	5/8"				0.14
BCV-1306DY		12.5	4.7	3/4"				0.18
BCV-1810DY		18	8	1"				0.34

• Standard valve material of BCV-1005DY is Polyamide resin.

## DIMENSIONS

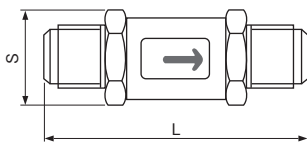

Type ACV-B

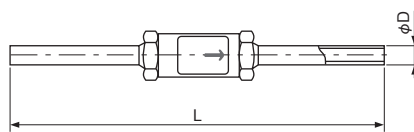

Type ACV-D

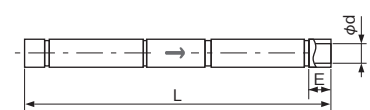

Type BCV-302DY to 804DY

Unit: mm

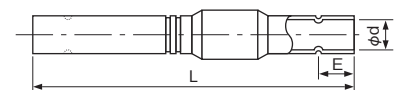

Type BCV-1005DY to 1810DY

### Type ACV

Catalog No.	Unit: mm		
	L	φD	S
ACV-2B	58	-	14
ACV-3B	76		19
ACV-4B	87		24
ACV-5B	103		30
ACV-6B	115		36
ACV-2D	120		6.35
ACV-3D	160	9.53	
ACV-4D	187	12.70	
ACV-5D	235	15.88	
ACV-6D	300	19.05	

### Type BCV

Catalog No.	Unit: mm		
	L	φD	E
BCV-302DY	112	6.55	-
BCV-603DY	120	9.71	8
BCV-804DY	140	12.93	13
BCV-1005DY	160	16.12	16
BCV-1306DY	180	19.30	19
BCV-1810DY	200	25.7	20